

Ulva Estate
The Pier Area

 Burdened
Property
181.5 sq m

Scale at A4
1:2,500
Drawn by: MM
Date prepared:
20/06/2017

Grid Ref. at
centre:
NM 444 398

BI Ref: U2678-1105M-ULVA-PIER
Rev 4

0 10 20 30 40 metres



Distances scaled from this plan
may not match the distances
between the same points on the
ground.

Reproduced from Ordnance
Survey digital map data © Crown
copyright 2017.

All rights reserved.
Licence number 0100031673



Durn, Isla Road, Perth, PH2 7HF
01738 621121
bellingram.co.uk
enquiries@bellingram.co.uk



Inset

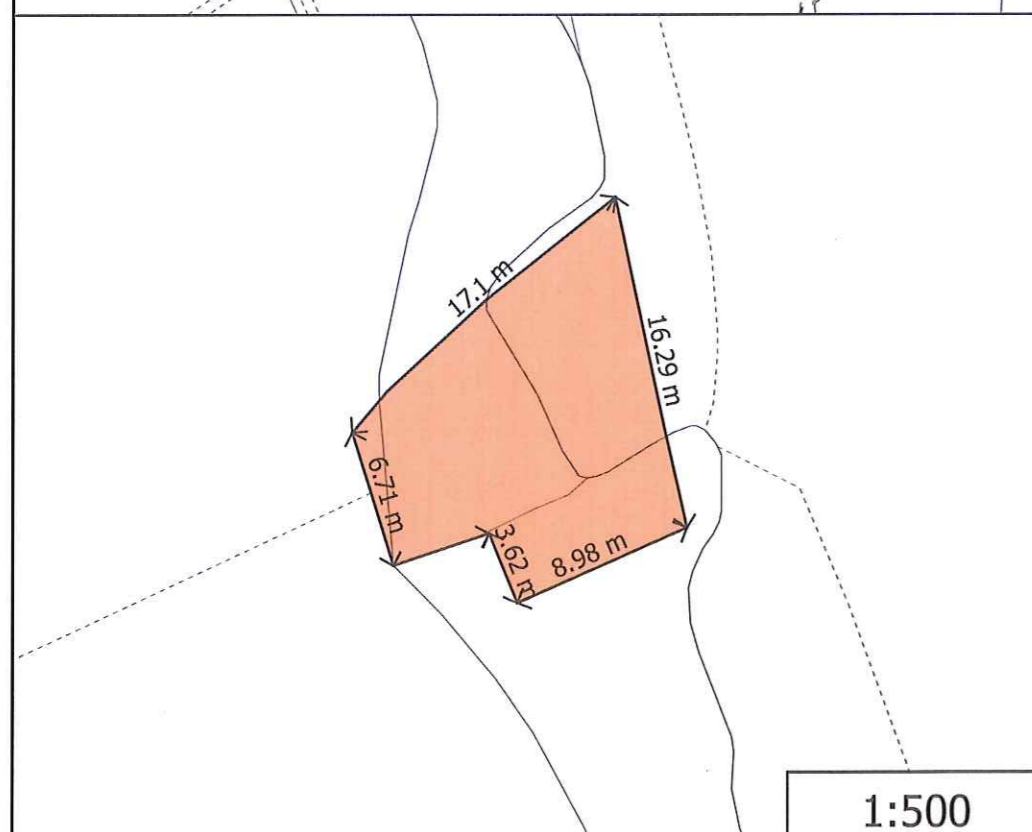

1:500

Gray C (Colin)

From: Paul Nicoll <paul.nicoll@bellingram.co.uk>
Sent: 26 September 2017 09:32
To: Hartil S (Stuart)
Cc: Paul Nicoll
Subject: Ulva - Formal Letter of Response - Your Ref ZLA/15/1
Attachments: September 25, 2017 Ulva - Formal Repsonse.pdf

Follow Up Flag: Follow up
Flag Status: Flagged

Your Ref: ZLA/15/1

Sent on behalf of Paul Nicoll

Dear Mr Hartil

I have pleasure in enclosing a copy of our formal response to the North West Mull Community Woodland Company's Limited application to register an interest in acquiring the Island of Ulva.

I would advise that the original copy will be with you today, along with all the annexations which would be too large to attach via email.

I would be most grateful if you could acknowledge safe receipt of the original letter and look forward to hearing from you in due course.

With kind regards.

Yours sincerely

Paul Nicoll MRICS
Consultant

Bell Ingram LLP, Boswell House, Argyll Square, Oban, PA34 4BD
T: 01631 566122 D: 01631 567793
bellingram.co.uk

Follow us on **twitter** like us on **facebook** visit our **website** or follow our **blog**
View our **latest properties for sale** and **properties to let**
For the Bell Ingram Review Click here

This email and any files transmitted with it are confidential and intended solely for the use of the individual or entity to whom they are addressed and should not be disclosed to any other party. If you have received this email in error please notify your system manager and the sender of this message. Bell Ingram do not accept any liability for viruses. Please ensure you have adequate virus protection before you open or detach any documents from this transmission.



Please consider the environment before printing this e-mail

Ref: Ulva U2678-1105M

This email has been scanned by the Symantec Email Security.cloud service.
For more information please visit <http://www.symanteccloud.com>

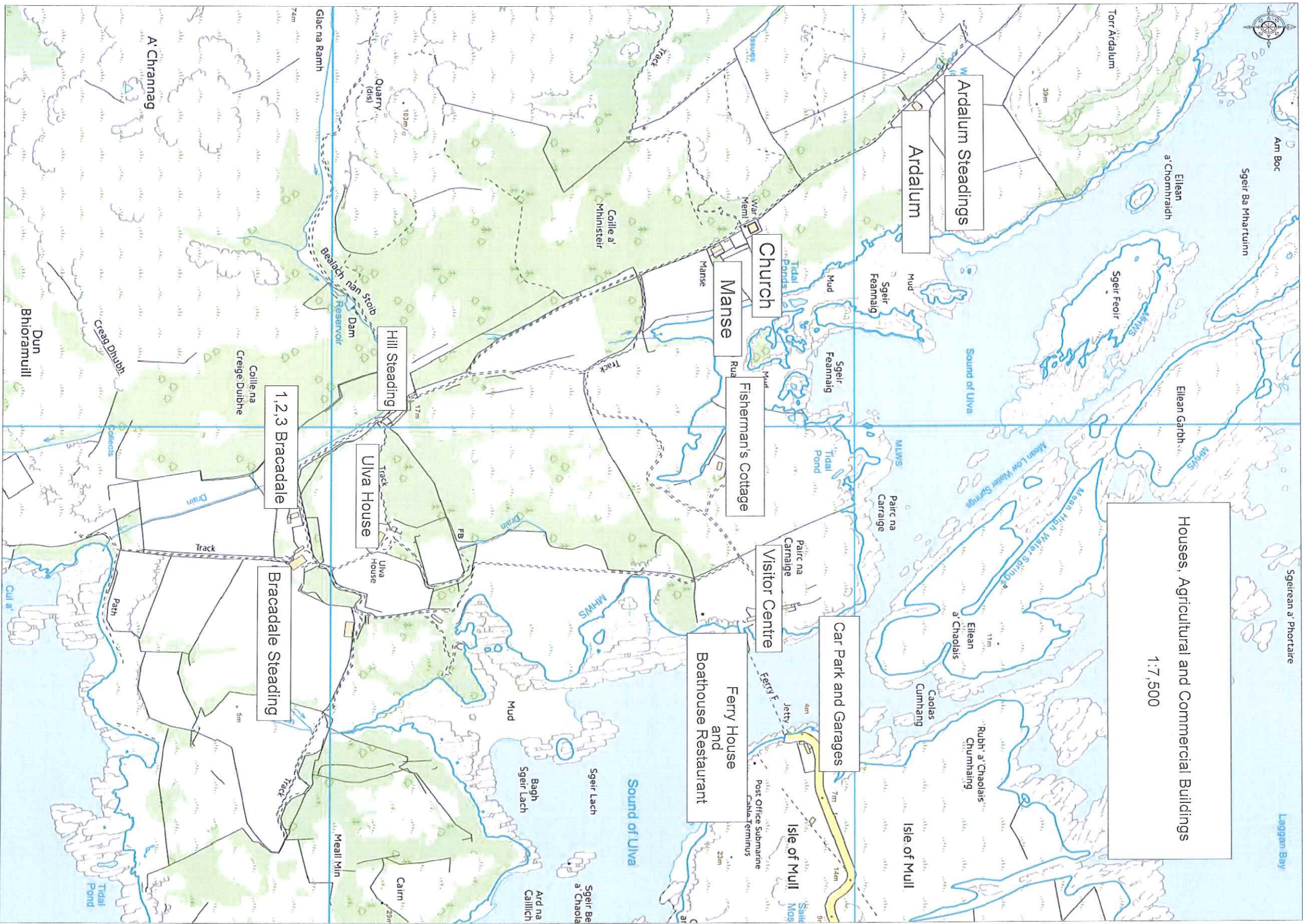

Houses, Agricultural and Commercial Buildings
1:7,500

Ardalum Steadings
Ardalum

Church

Manse

Hill Steading

Uiva House

Bracadale Steading

Car Park and Garages

Ferry House and Restaurant

A' Channag

Dun Bhoramuill



Occupied Houses

Craigaig

Berners

Berners and Craigaig
1:25,000



**Required Road Infrastructure
Island of Ulva
As Proposed by NWMCW Ltd**

**Road Proposed Croft at Bernais
3.083 km**

**Optional Road
984.180 m**

**Essential Public Road
1.606 km**

**Route of Road to Proposed Croft at Crackaig
No Road for 2.1 km
2.986 km (1.856 miles)**



**Required Road Infrastructure
Island of Ulva
As Proposed by NWMCW Ltd**

**Road Proposed Croft at Bernais
3.083 km**

**Optional Road
984.180 m
Cost £2,362,000**

**Essential Public Road
1.606 km
Cost £3,360,000**

**Route of Road to Proposed Croft at
Crackaig
No Road for 2.1 km
2.986 km (1.856 miles)**